

PI PYE INTERIORS



Creating spaces that invite, support and inspire.

“I believe that successful projects are the result of an active, working relationship grounded in mutual trust between the client and the designer - a true partnership.”

*Linda Pye, IIDA, ASID
Principal, Pye Interiors*

Most people believe there is magic in what we do. We take a room, a suite, a building and transform it into something totally new and different. The transformation process can be exciting and fun, but it can also be overwhelming and time consuming. That's where we come in. Our team of designers will not only make it an enjoyable process, but we guarantee you'll be pleased with the results!

We create interior solutions that incorporate color, furniture, lighting, architectural detailing, signage and branding. In addition to all of the "creative stuff," we focus our energies on project management and excellent customer service so your project gets done on time and on budget.

Pye Interiors is a full service design firm located in Charlottesville, Virginia, specializing in design for higher education, health care and corporate interiors. Founded in 1995, we are certified with the State of Virginia as a small, woman-owned business.

We'd like to share some of our "magic" with you. Browse through our portfolio for inspiring ideas for your project.



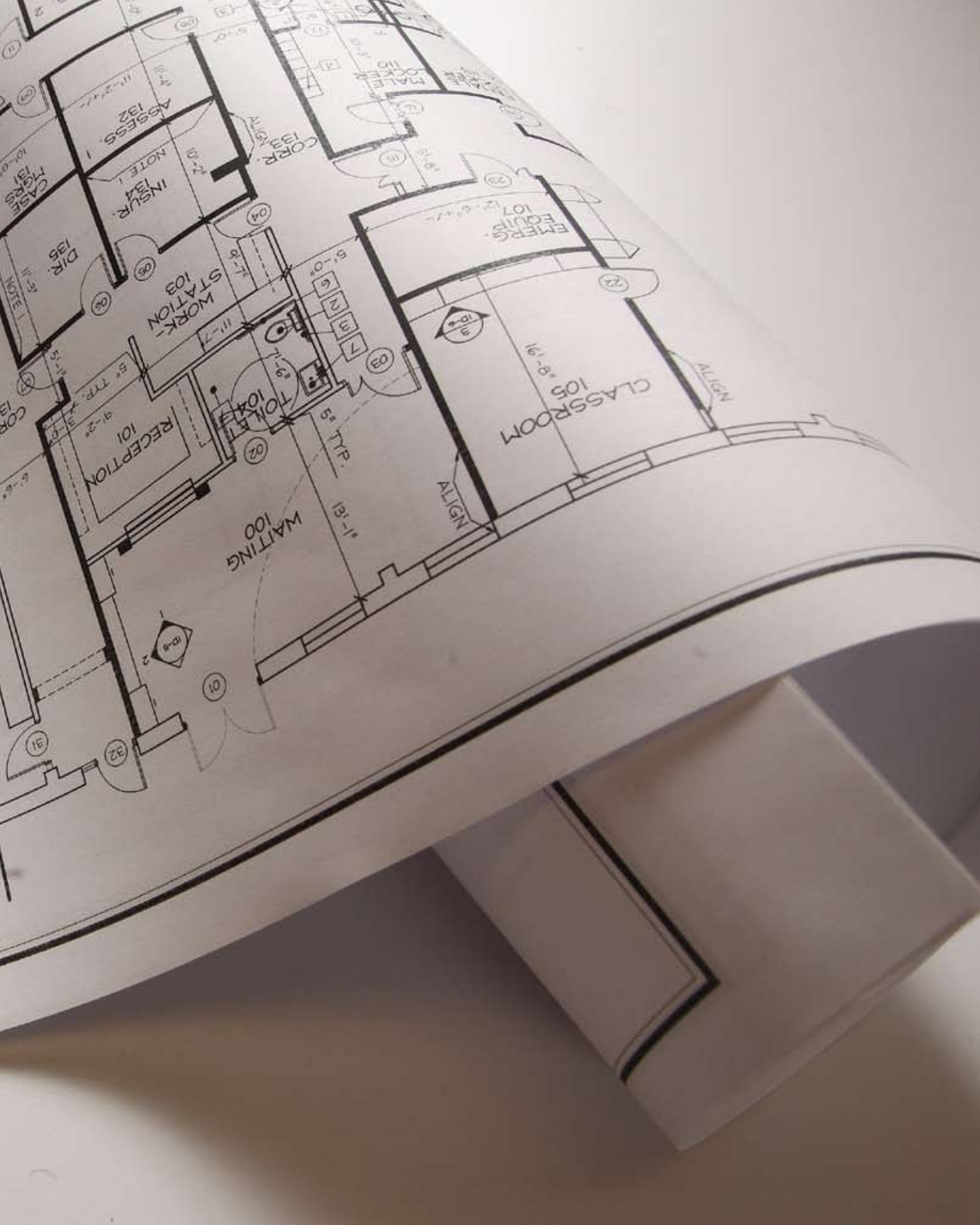

Imagining Higher Education Space

Learning takes place in a variety of ways. Our goal is to understand what is needed to support both the teacher and the student. First, we consider the teacher's desire for friendly technology, dimmable lighting and flexible furniture in the classroom setting. Then we think about the student's needs as they sit through lectures, socialize between classes, get together with classmates to work on projects, and search out a quiet study spot. Once we have determined the needs, we look for solutions in furniture and finish materials that offer durability, ease of maintenance, comfort, flexibility and aesthetics, creating practical environments that support and inspire all forms of learning.



“What I appreciate most about working with Pye Interiors is their availability and responsiveness. They did an excellent job of listening and responding to a complicated program and delivering a concise set of standards for color palettes, furniture and signage. They pulled all the parts into one complete aesthetic package.”

*Gerry Starsia, Associate Dean Administration
University of Virginia McIntire School of Commerce*



McIntire School of Commerce

at the University of Virginia, Charlottesville, Virginia

This prestigious project involved designing state-of-the-art classrooms and offices while paying homage to history and tradition.

In 1898, Rouss Hall was designed by the architects McKim, Mead & White to complete the South End of Thomas Jefferson's Lawn. In 2008, The McIntire School of Commerce proudly moved "Back to the Lawn" into the combined 156,000 square foot renovation and addition.

We began working with the Commerce School three years prior to their move on the selection of interior color schemes, furnishings and signage. They requested that the building have personality and color, so we responded with bold, historic choices that accentuate the architectural mouldings, columns and coffered ceilings. The style of the furnishings varies by area with some reminiscent of the early 1900s, and others more contemporary with a focus on supporting today's technology. The sophisticated contrast of old and new can be seen throughout this facility of classrooms, group study rooms, technology centers, student lounges, faculty offices and administrative areas.





School of Law

At the University of Virginia, Charlottesville, Virginia

To foster interaction between the students and the faculty, the School of Law built a 30,000 square foot addition that included a Student Commons, Casual Dining Area, Faculty Dining Area and Reading Room. Working with a project committee, we presented recommendations for furniture, upholstery, and area rugs. Our selections included classic contemporary furnishings that enhanced the interior architecture and were durable enough to withstand constant student use.



“Pye Interiors did an outstanding job of completing the architectural design of our new space by assisting us in the choosing of furniture, fabrics and rugs. Their patience, persistence and refined judgement helped ease our decision-making process and gave us, in the end, an excellent result for which we are grateful.”

*Bill Bergen, Assistant Dean for Administrative Services
University of Virginia School of Law*



Alumni Hall

at the University of Virginia, Charlottesville, Virginia

Located in the middle of Alumni Hall, the Virginia Room serves as the “living room” for visiting alumni. It is a multi-functional room serving as a meeting space, business center, lounge, boardroom, and overflow space for the adjacent ballroom. The furniture layout often changes several times in a day just to accommodate the variety of scheduled events.

Our goal was to create a room that always looks complete, with classical detailing and a turn-of-the-century feel reminiscent of the University’s long and proud history.



“What I valued most about working with Pye Interiors was their flexibility in working with our committee of people with various opinions. When we decided we wanted to head in a different direction mid-way into the project, Pye Interiors was willing to start over and still respond in a timely fashion. They were able to address both the look and functional requirements in the design and gain the trust of the committee.”

*David Robey, Director of Facility Operations
University of Virginia Alumni Association*

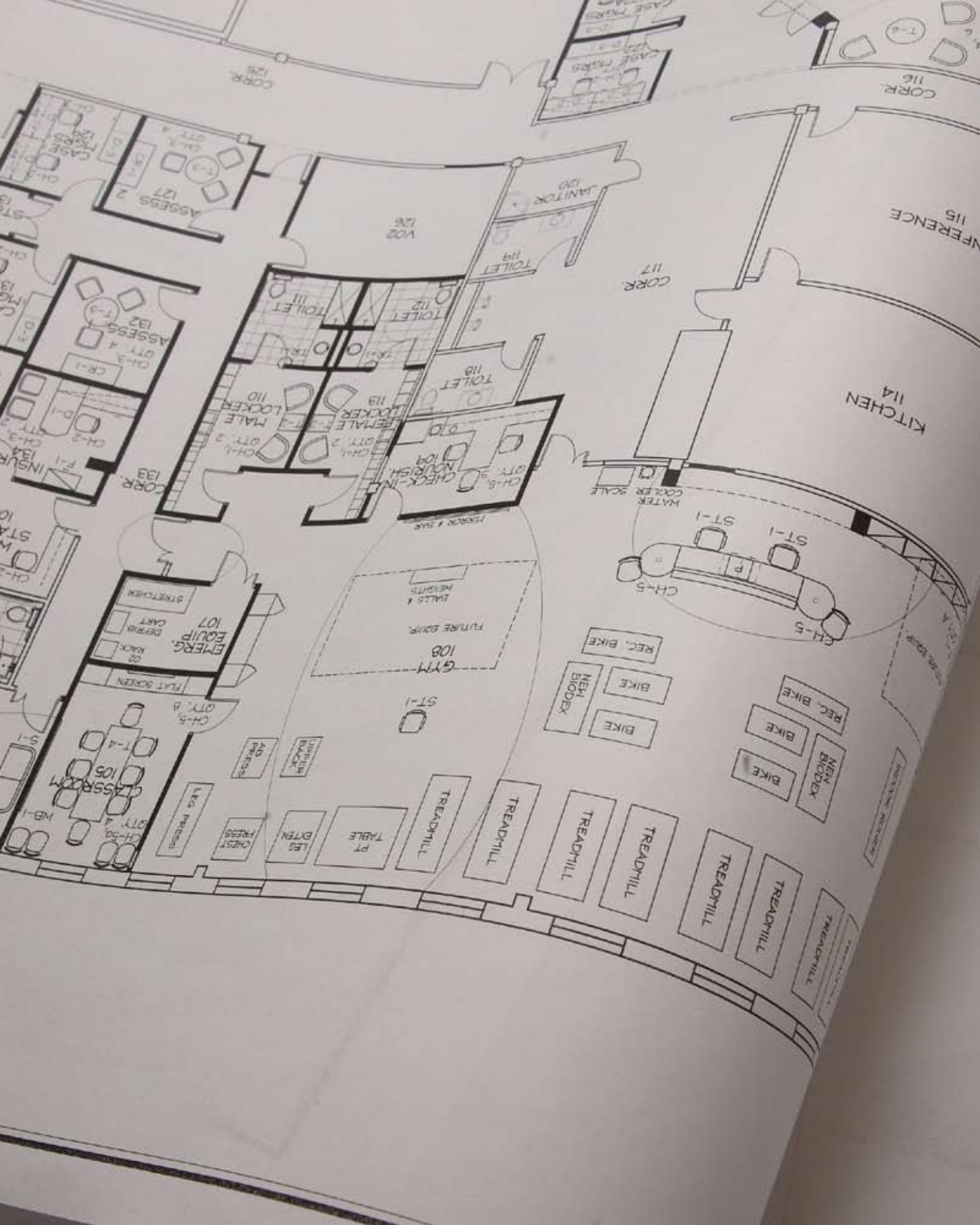

Planning Health Care Space

We begin every health care project by imagining ourselves as the patient. From that point forward all of our design decisions are focused on balancing the patient experience, the needs of the medical staff, and the performance of the facility. We use quiet colors, understated tones, and themes of nature to support the healing process and the morale of the medical staff. We plan for spaces that not only accommodate the necessary medical equipment, staff work areas and supplies, but also offer comfort and privacy for the patient. We know it's the little touches that can make the biggest difference ... a cushioned chair that rocks, soft lighting, warm colors, natural materials, inspirational artwork, and sunlight ... providing a holistic approach to patient care.



Our new office has had a phenomenally positive impact on our patients, my staff and myself. Since moving to the office three years ago, we have seen an incredible increase in the numbers of new patients ... I attribute this to the design developed by the team at Pye Interiors.”

*Dr. Jay Knight, DDS
Jay Knight & Associates Family Dentistry*



Orthopaedic Center of Central Virginia

Lynchburg, Virginia

Pye Interiors worked closely with the Orthopaedic Center of Central Virginia on the interior design of their new 3-story, 80,000 square foot building. The facility includes clinic space for twelve physicians, an MRI suite, a Physical Therapy Gym and Administrative Offices and was designed with the patient in mind. Warm and welcoming spaces provide patients with a sense of safety, comfort and dignity, while nature images in the artwork and signage support the healing process and the morale of the patients, medical staff and visitors.

The signage and wayfinding package included directorires and room identification signs with printed inserts, suite entry signage, overhead wayfinding signage and a custom logo wall. Photographs of flowers, trees and grasses are used by medical staff to direct patients in finding their way from one department to another.





Jay Knight & Associates Family Dentistry

Charlottesville, Virginia

Is it possible to design a dentist's office that you can look forward to visiting?

In our first meeting with Dr. Jay Knight, we walked through his lease-space that showed the remains of a very old, outdated, and institutional clinic. He challenged us to imagine a clean slate and create a "hip and cool" office for his new practice. We introduced dramatic color, accent lighting and warm wood tones for a dynamic environment that welcomes patients and reduces anxiety. The 1,600 square foot suite includes a waiting area, business office, consult room, two hygiene bays, three treatment bays, a lab, a private office and staff lounge.





Jefferson Obstetrics and Gynecology

Charlottesville, Virginia

When this growing practice of seven physicians was relocating their office from a basement space in a 30-year old building to the third floor of a brand new office building, they requested a light and bright interior that would appeal to women of all ages!

After presenting the doctors with several color scheme options, this feminine color palette of bright blues, greens and light maple wood tones was selected for its home-like feel. Custom millwork in an “arts-and-crafts” style continues the residential detailing in the waiting area and exam hallways, providing warmth and elegance to this commercial

space. The 6,000 square foot clinic includes 12 exam rooms, an ultra-sound room, a procedure room, a business office, private offices for the physicians and office manager and a staff lounge.



Creating Corporate Space

We believe that offices need to be designed as places where people want to be — supporting not only the work function, but the spirit of the users. Our first step is to get to the heart of your business, know your goals, define your culture, and understand how you get work done. Then we design an environment that provides what you need — quiet places for concentrated work, teaming areas for collaborative exchanges, and flexible meeting spaces that encourage creativity and innovation. We select furnishings and lighting that provide flexibility and comfort for the user while also accommodating the latest technology.

Our job is to help you do your job!



“Pye Interiors relieved me of the burden of designing the new office so I could focus on running the business. They handled all the details of construction, furniture, artwork and company graphics and pulled it all together for a professional look.”

*Andrew Lee, Vice President & COO
Hauser Homes*



Hauser Homes Corporate Office and Design Center

Charlottesville, Virginia

After purchasing this former appliance showroom and warehouse to accommodate their new Corporate Offices and Design Center, Hauser Homes contacted us for guidance on how to turn this shell space into a functional and collaborative space. They wanted a formal reception area to welcome their clients, but a casual atmosphere for their employees that maintained the feel of the original warehouse. In working with Hauser Homes, we presented three color scheme options, several space plan layouts and concept drawings to illustrate our ideas for the interior detailing. A clean, linear design and a rich, dark color palette was selected. We also presented brochures of furniture recommendations, a budget and eventually sample chairs for them to try out. After receiving their approval, we prepared the drawings and specifications used for bidding and construction.

At the center of Hauser Homes' new office suite is a warm & inviting "company café". The café fosters daily communication among project teams and serves as the location for weekly company meetings.

The 8,700 square foot office suite includes a reception area, large conference room, small conference room, copy room, 13 private offices, and the company café.





The Oak Crest Companies

Winchester, Virginia



The goal of this extensive rehabilitation for the Oak Crest Companies was to expose as much of the historic building as possible while introducing new modern furnishings and details for a dramatic and comfortable office suite. Reclaimed heart pine floors and lyptus millwork were selected to compliment the old brick and original wood ceiling beams of this former textile mill dating back to

1895. Everything from the paint colors and carpets to the furnishings and lighting were all selected to enhance the natural beauty of this old structure. The 26,500 square foot building includes a reception area, training center, five conference rooms, 41 private offices, two staff lounges, and an exercise room.





After 100 years in the industry, First Bank was ready to update their image. They came to us with sketches, ideas, and photos. We helped them to refine their vision of a contemporary retail-focused banking facility into a complete interior package ... with finish materials, custom millwork, lighting, furniture, artwork, signage and retail displays.

Since the creation of that first branch in 2000, we have designed multiple branches, corporate offices and an operations center, utilizing the interior package for a consistent and strong corporate identity.



"I hire Pye Interiors because I want a well-designed project and I value their expertise in selecting the appropriate style, color, etc. Beyond that, they are tremendous project managers. I am confident that they will take a project from start to finish and always get it done on time and as promised."

*Dennis Dysart, Senior Vice President
First Bank*

Linda Pye, IIDA, ASID

Principal Designer

Linda Pye founded Pye Interiors in 1995. With over two decades of experience, Linda focuses on innovative solutions, design excellence and outstanding customer service. These ideals have resulted in the successful formation of numerous long-term client relationships which make up the majority of the firm's work.

Linda holds a BFA in Interior Design from Virginia Commonwealth University and has maintained professional membership with the International Interior Design Association since 1987.

Linda began her career in Washington D.C. where she focused exclusively on corporate office design. After eight years, she relocated to Charlottesville for a position at the University of Virginia Medical Center, beginning her concentration on health care design. Since establishing her own firm, Linda has augmented her corporate and health care design experience and now also offers a specialty in higher education design.

Her firm maintains term contracts with three state universities (Virginia Commonwealth University, University of Virginia, and James Madison University), as well as long-term relationships with corporate clients and hospitals throughout the state of Virginia.



“Our philosophy is to create great spaces that invite you ... support you ... and inspire you.”

*Linda Pye, IIDA
Principal, Pye Interiors*

PI PYE INTERIORS

100 10 Street NE
Charlottesville, VA 22902
434.971.1393
www.pyeinteriors.com